

330300

330400

PROPOSED EXTINGUISHMENT A ————— B
 PROPOSED DIVERSION C - - - - - B

PUBLIC FOOTPATH - - - - -
 PUBLIC BRIDLEWAY - - - - -
 BYWAY OPEN TO ALL TRAFFIC - - - - -

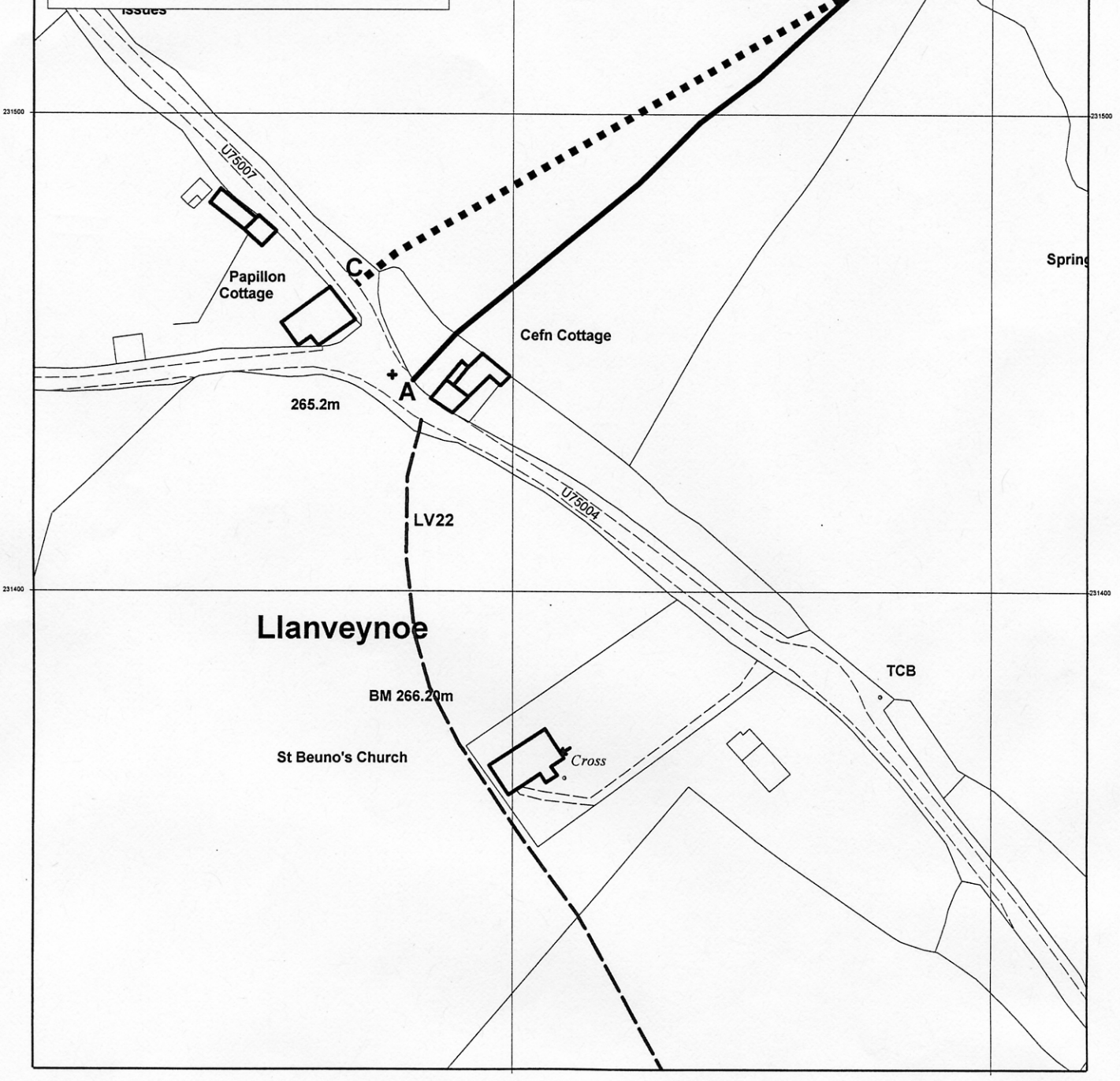

LOCATION PLAN - PARISH OF LLANVEYNOE
PROPOSED DIVERSION OF PUBLIC
FOOTPATH LV59 (PART)
 DWG No. D283/244-59
 SCALE 1:1250



Herefordshire Council
 Public Rights of Way
 PO Box 236
 Hereford
 HR4 0WZ
 Tel.: (01432) 260000
 Fax.: (01432) 383031

Reproduced from Ordnance Survey mapping with the permission of the Controller of Her Majesty's Stationery Office.
 Crown Copyright. Unauthorised reproduction infringes Crown copyright and may lead to prosecution or civil proceedings. 100024168, 2004.
 This information is based on that currently available to the County of Herefordshire District Council from the Definitive map and Statement and other public records. It is given on the strict understanding that neither the Council nor any of its officers will be responsible for the accuracy of this information or accept any liability whatsoever for any error or omission therein for any loss or damage arising from interpretation or use of the information supplied. The inquirer should rely on the results of their own investigations.